



120 W DC- 4 GHz SMA/male COAXIAL TERMINATION

issue
04.apr.96

Page
1 / 2

R F CHARACTERISTICS

FREQUENCY RANGE : DC - 4 GHz
 IMPEDANCE : 50 Ohms
 DC RESISTANCE : 50 Ohms ± 5 %
 V.S.W.R : DC - 1 GHz : ≤ 1.10
 1 - 2 GHz : ≤ 1.20
 2 - 4 GHz : ≤ 1.30
 PEAK POWER at 25°C (1µs,1%.) : 5 kW
 AVERAGE POWER at 25°C : 80 W (convection cooled)
 : 120 W (conduction cooled) *

MECHANICAL CHARACTERISTICS

CONNECTORS : SMA male per MIL-C 39012
 WEIGHT : < 800 g

ENVIRONMENTAL CHARACTERISTICS

OPERATING TEMPERATURE RANGE (°C) : -55 , +125
 STORAGE TEMPERATURE RANGE (°C) : -55 , +125

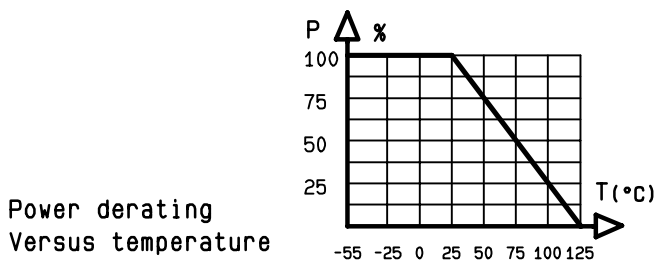

* :a 156 sq. in. plate x1/8" (1000 cm² x 3 mm) is required

This information is given as an indication. In the continual goal to improve our products, we reserve the right to make any modifications judged necessary

CREATION				
N° :				
PEN/EP:95182				
Name:KL	04.apr.96	55,6 ±0,5 --> 56.1 max.	MLG	VE
Date:29.apr.91	03.nov.92	New format	PG	
APP.:	ISSUE	REVISIONS	NAME	APPR.

RADIAL[®]

101. rue P. Hoffmann -Z.I Quest-
 93116 ROSNY/BOIS Cedex-FRANCE
 Phone :33(1)49353535
 Fax :33(1)48546363
 Twx RADIA 235220F

R404884000

issue
04.apr.96

Page
2/2

DRAWING

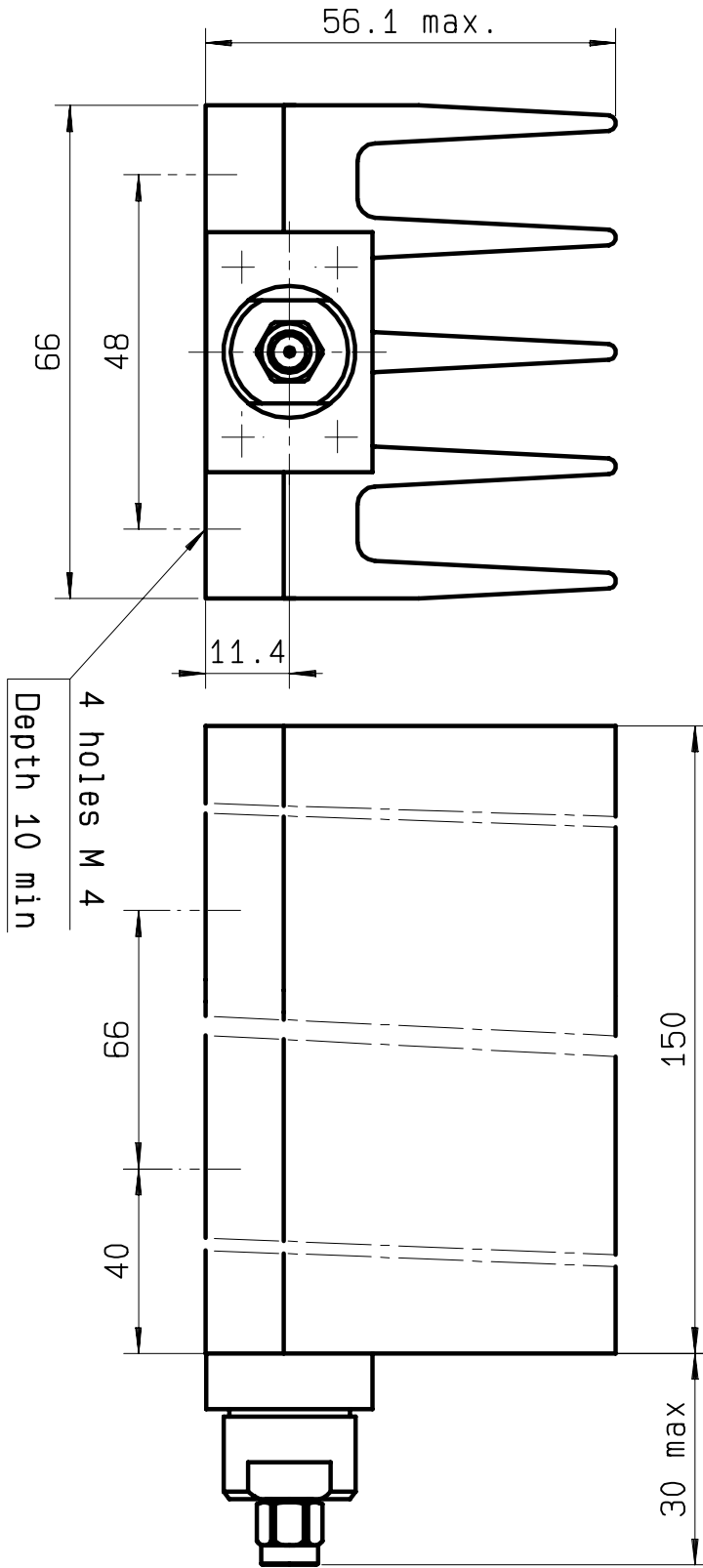

General tolerances:
+/- 0.5 mm

This information is given as an indication. In the continual goal to improve our products, we reserve the right to make any modifications judged necessary

4113-9212